

HOW TO CAT PROOF A Balcony

What You'll Need:

- Chicken wire PVC
- Cable ties
- Staples
- Hooks or eye screws
- Protective gloves
- Wire cutter
- Tape measure
- Marker
- Drill
- Hammer

1 Plan & Measure

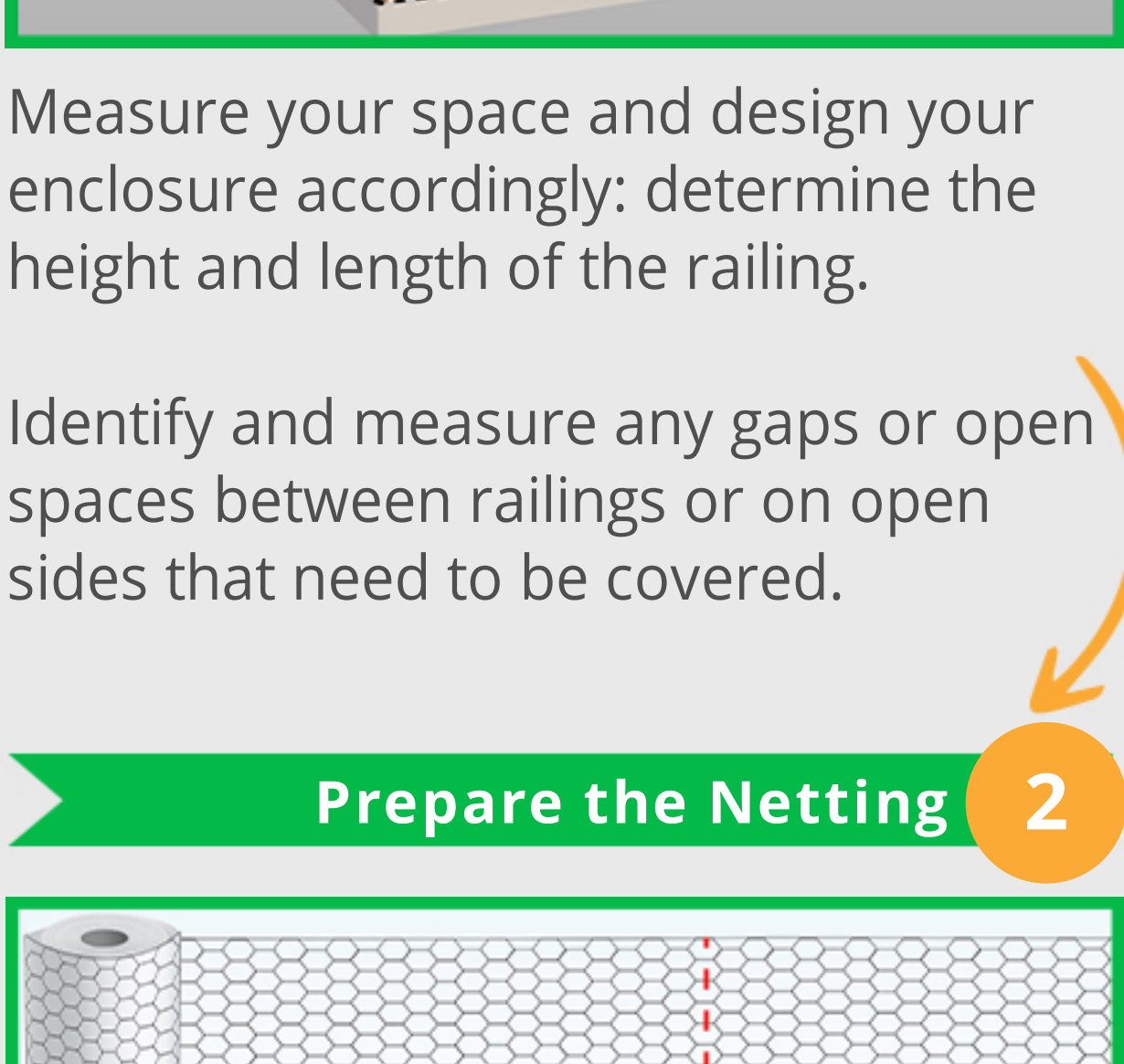

Measure your space and design your enclosure accordingly: determine the height and length of the railing.

Identify and measure any gaps or open spaces between railings or on open sides that need to be covered.

2 Prepare the Netting

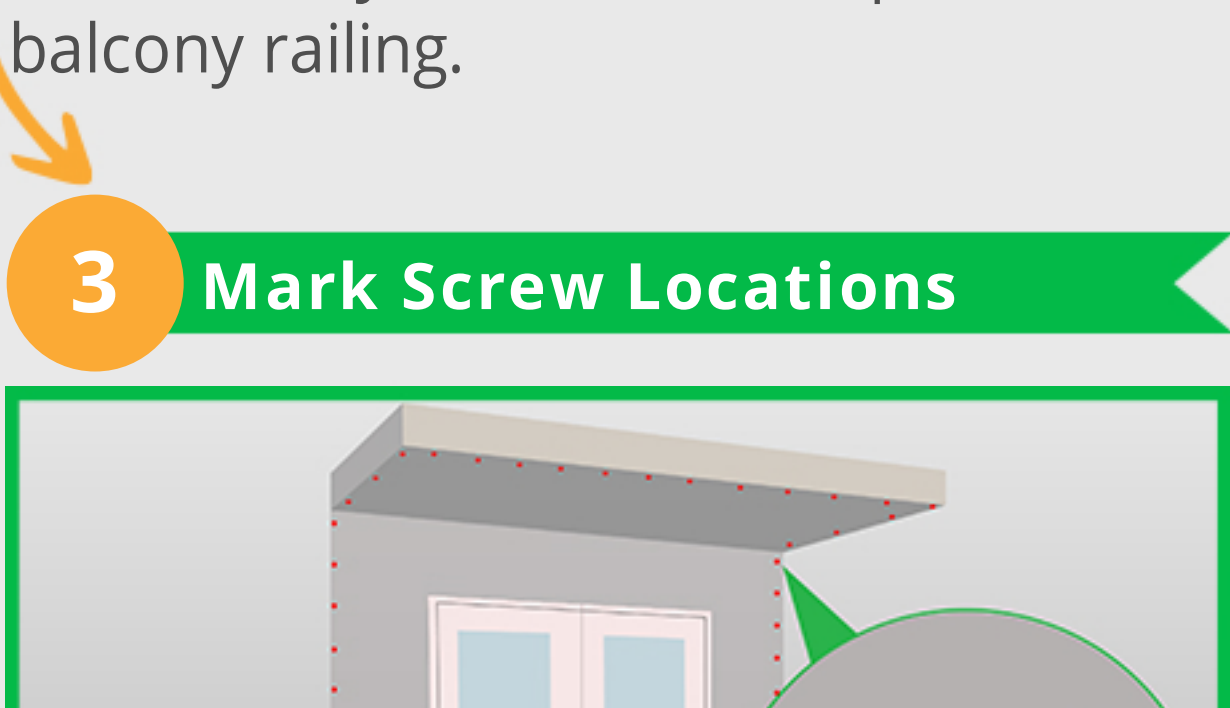

Use wire cutters to cut the chicken wire to the appropriate lengths, adding a few extra centimeters to each piece for securing the wire at the top and bottom.

Mesh or netting is one of the most efficient ways on how to keep cats off balcony railing.

3 Mark Screw Locations

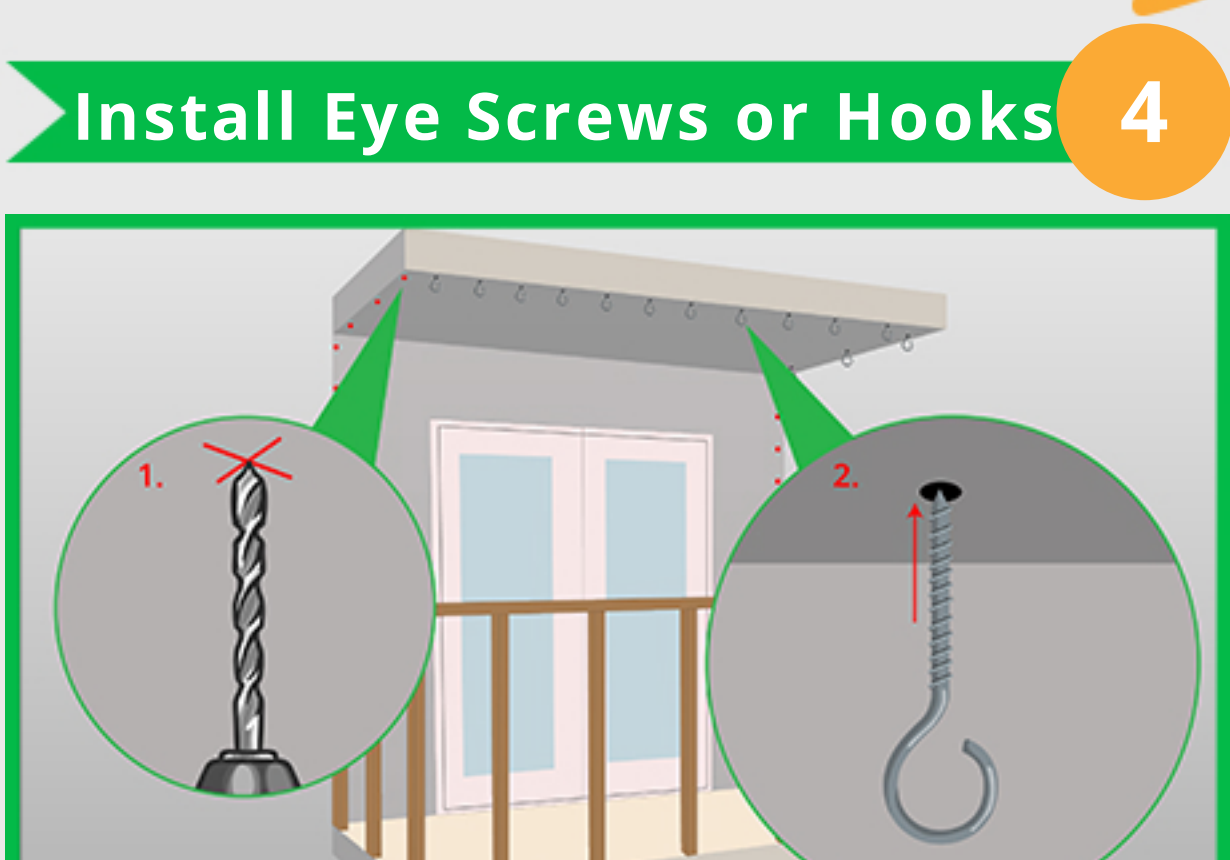

You'll need to attach the netting to something at the top and on both sides of the terrace.

Mark the locations where you will install hooks or eye screws, spacing them every 15-30 cm.

4 Install Eye Screws or Hooks

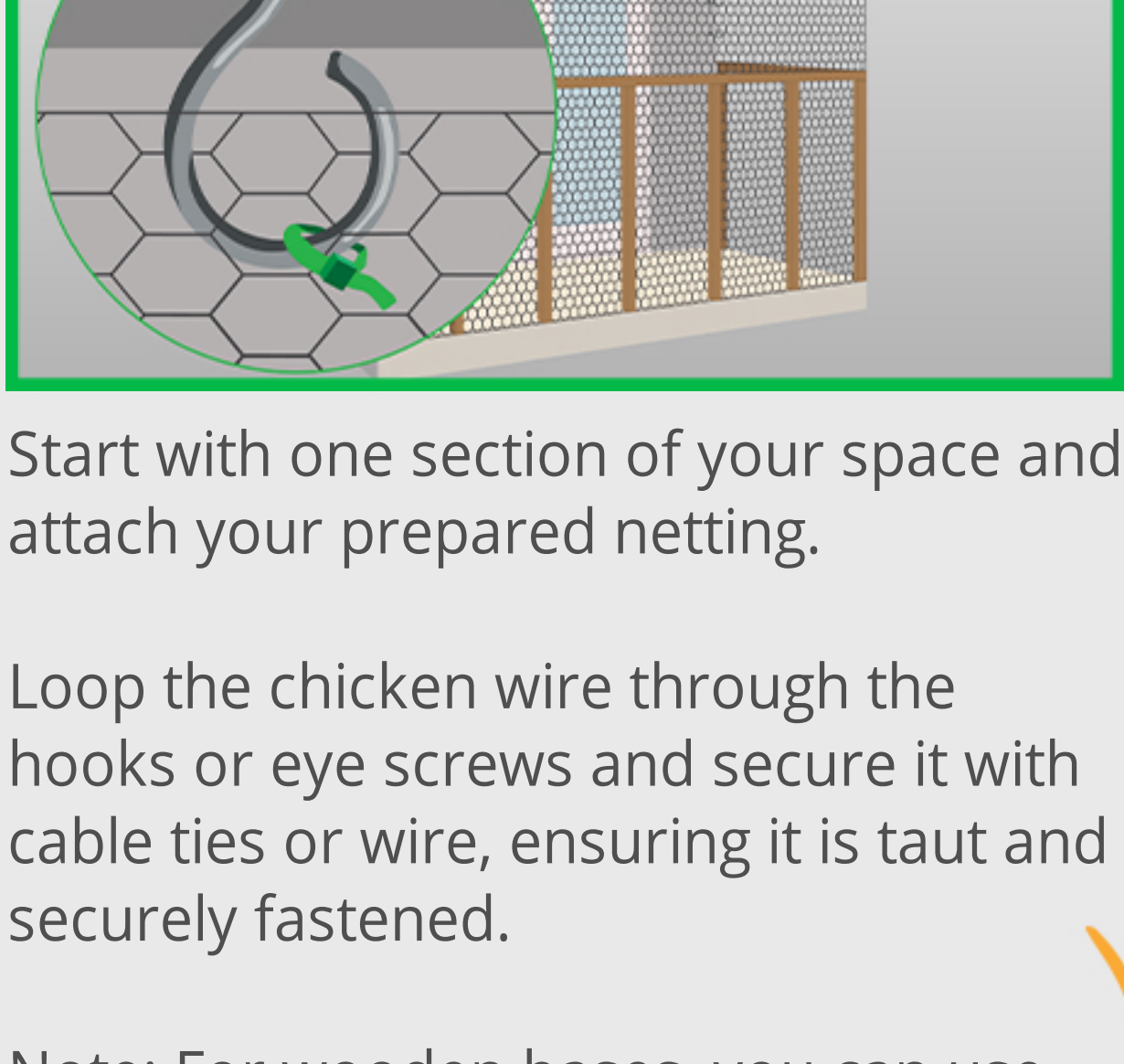

Drill pilot holes at the marked locations if needed.

Securely screw in the hooks or eye screws into the solid base.

5 Attach Wire to Hooks

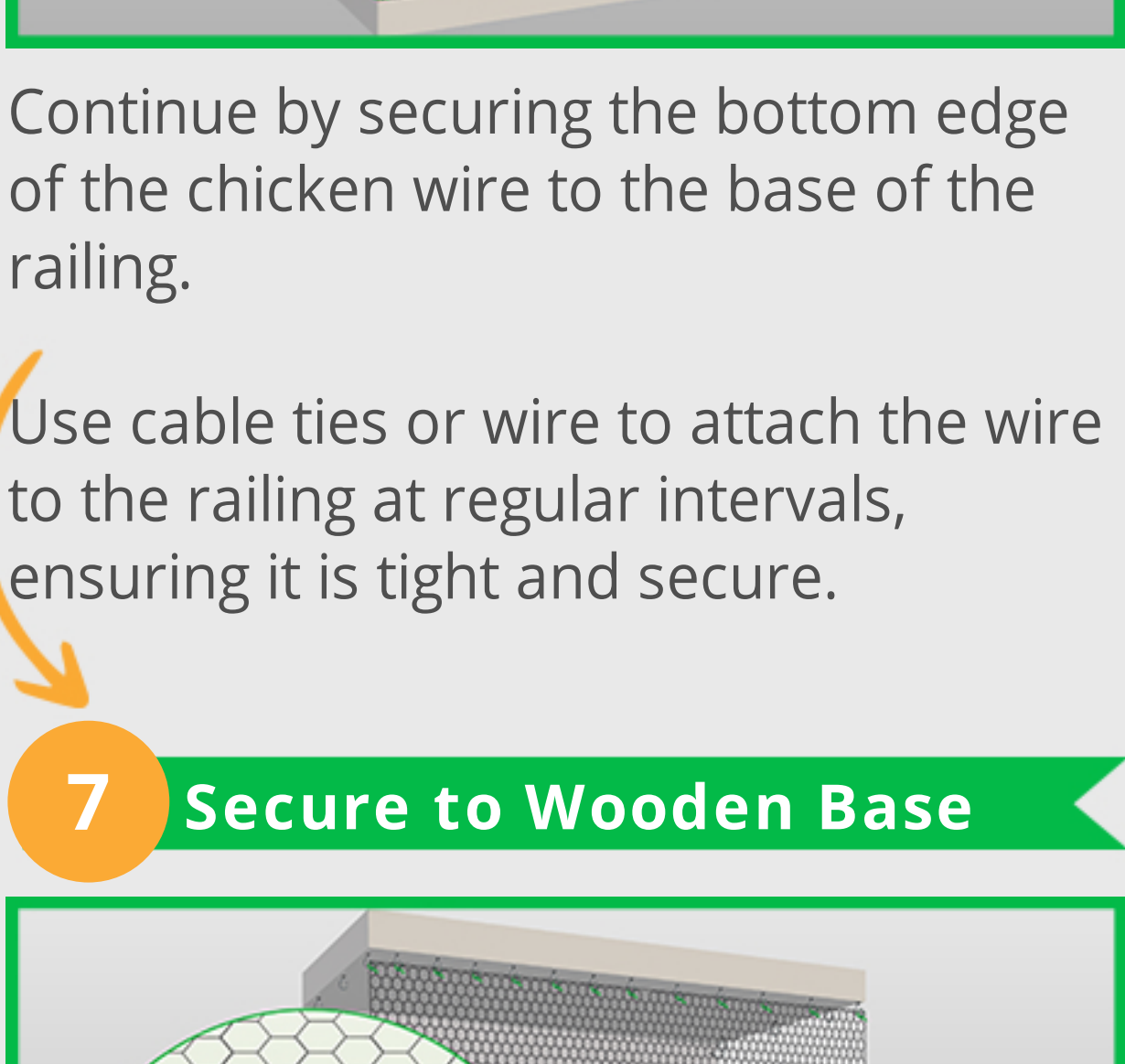

Start with one section of your space and attach your prepared netting.

Loop the chicken wire through the hooks or eye screws and secure it with cable ties or wire, ensuring it is taut and securely fastened.

Note: For wooden bases, you can use staples.

6 Secure Bottom to Railing

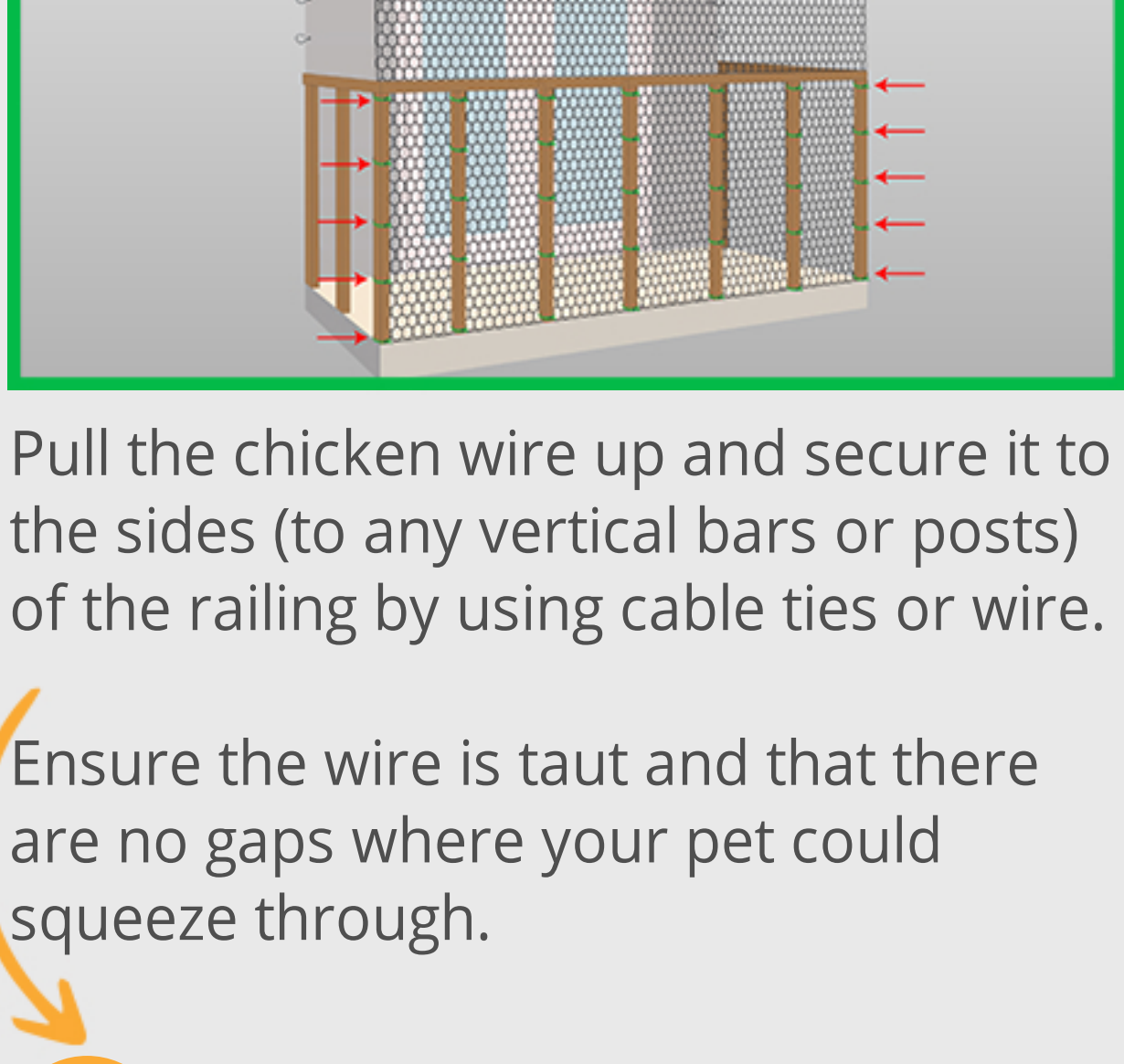

Continue by securing the bottom edge of the chicken wire to the base of the railing.

Use cable ties or wire to attach the wire to the railing at regular intervals, ensuring it is tight and secure.

7 Secure to Wooden Base

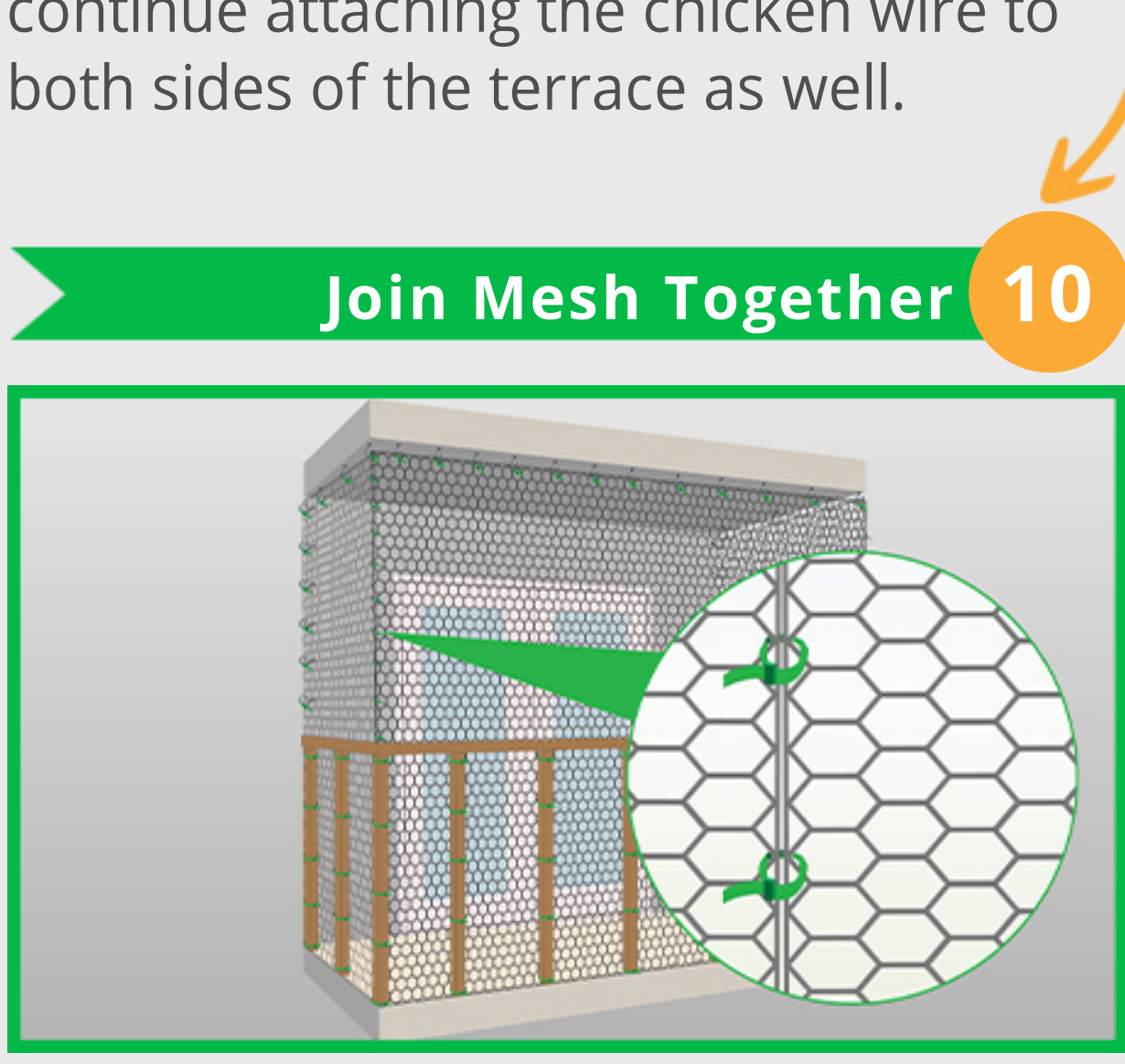

If your balcony has a solid wooden base, you can use staples at 15cm intervals to attach the wire, ensuring the staples are securely fastened.

8 Attach on the Sides



Pull the chicken wire up and secure it to the sides (to any vertical bars or posts) of the railing by using cable ties or wire.

Ensure the wire is taut and that there are no gaps where your pet could squeeze through.

9 Install Remaining Areas

Following the process of how to cat proof a balcony described in steps 2-7, continue attaching the chicken wire to both sides of the terrace as well.

10 Join Mesh Together

Join the mesh together at the corners using cable ties or wire ties.

If your netting is not large enough, you can easily join two pieces of mesh together in the same way.

11 Furnish & Supervise

Fill any gaps with smaller pieces of wire, securing as before.

Test the installation by pushing to ensure it's secure before letting your feline onto the balcony. Also, check for loose spots and gaps.

Inspect the chicken wire edges for sharp points or edges.