

# HOW TO MAKE A GABION LETTERBOX

## Step by Step

### What You'll Need:

- Protective Gloves
- Bolt Cutter
- Angle Grinder
- Mailbox
- Gabion Baskets
- Helical Corners
- Stones

### 1 Unfold gabion



Unpack the gabion, ensuring all sides are properly unfolded and ready for assembly.

### 2 Cut the helicals to size

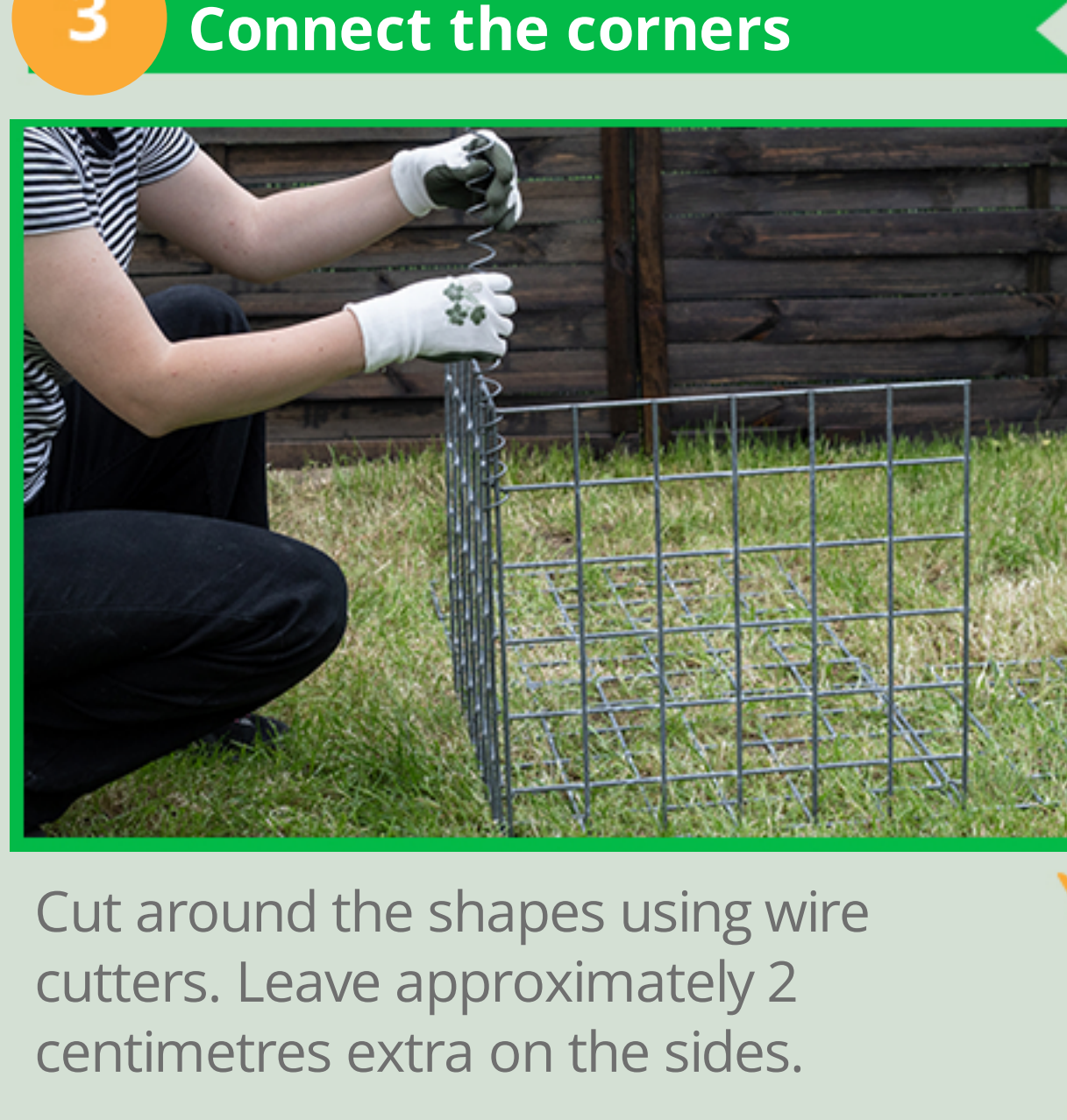

Measure the dimensions of the gabion panels and cut the helicals to match accordingly.

### 3 Connect the corners



Cut around the shapes using wire cutters. Leave approximately 2 centimetres extra on the sides.

### 4 Measure your planter



Measure your planter pot and mark where you have to cut the lid panel.

### 5 Add the top gabion basket



Assemble the second gabion following the same process. Place it on the first gabion, which is already filled with stones.

### 6 Join the two gabions



Use helicals to join the corners of the two baskets together. Make sure they enclose the corners of both basket's panels.

### 7 Fill the second gabion



Continue filling the second gabion with stones.

### 8 Attach mailbox to gabion



Place a wooden plank inside the gabion. Make sure the screw is right above a horizontal wire and the mailbox is positioned where you prefer.

### 9 Secure the mailbox

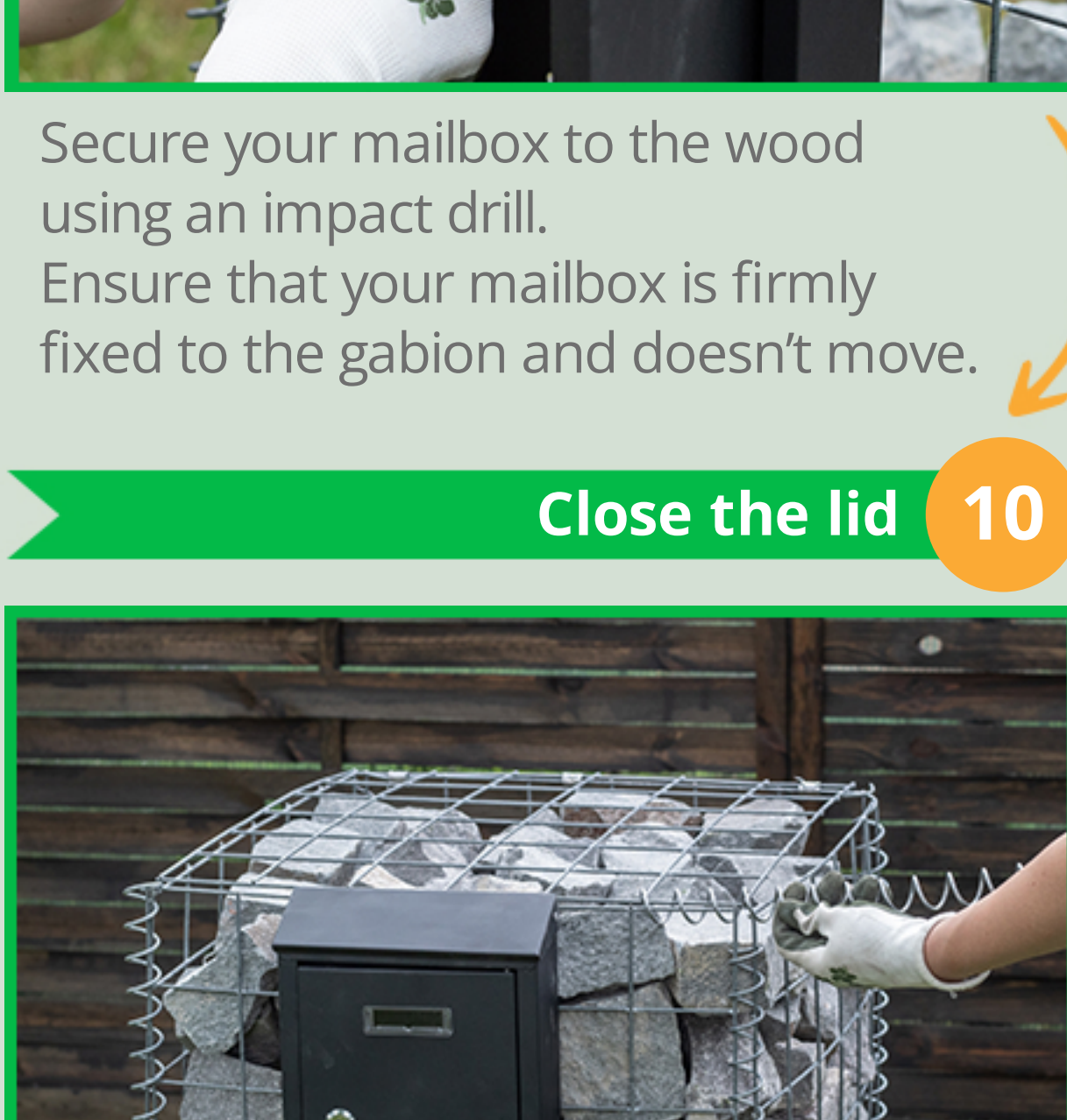

Secure your mailbox to the wood using an impact drill. Ensure that your mailbox is firmly fixed to the gabion and doesn't move.

### 10 Close the lid

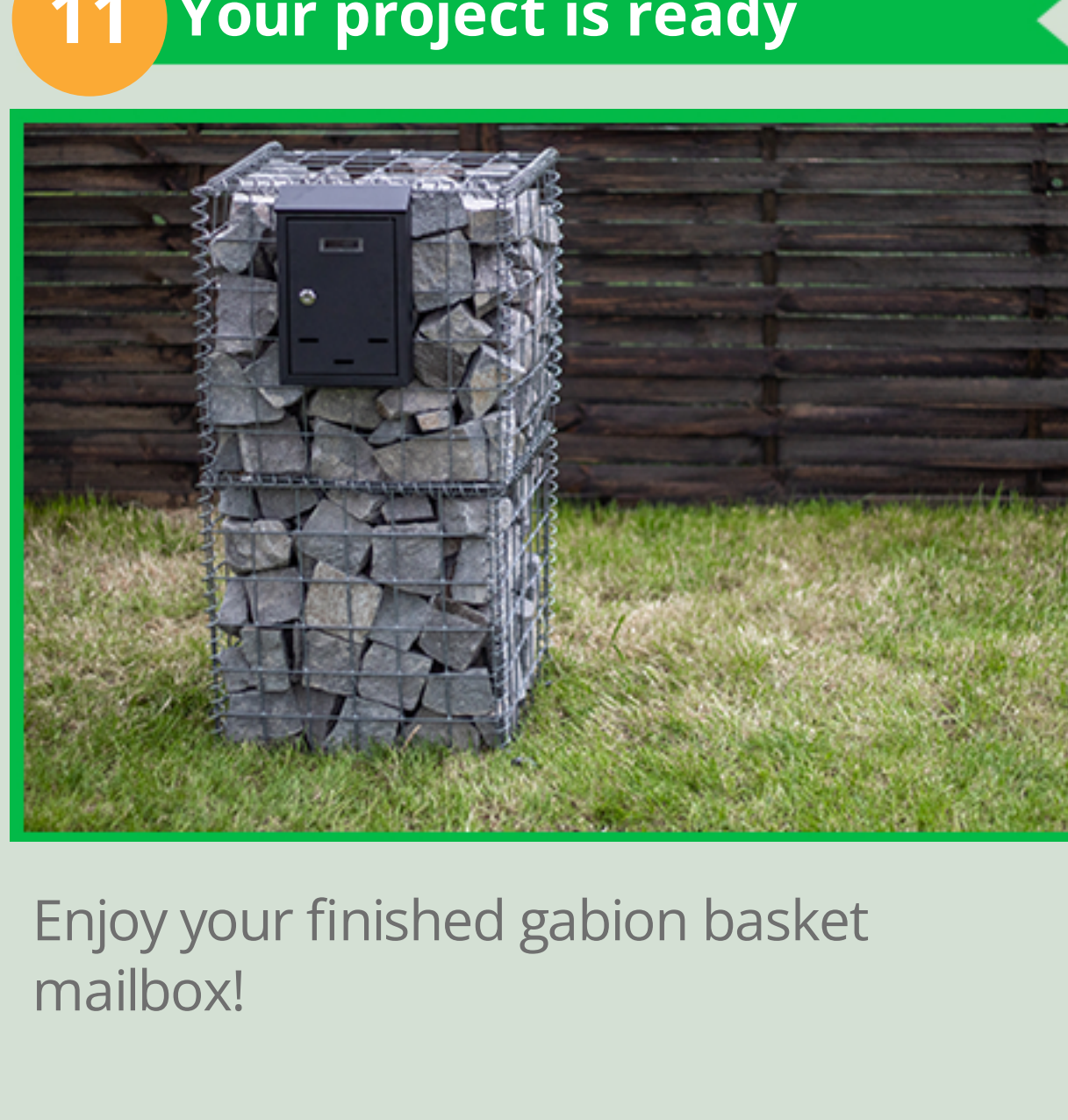

Close the lid of your gabion basket with helicals.

### 11 Your project is ready



Enjoy your finished gabion basket mailbox!