

# DIY SPRING WREATH

## *With Chicken Wire*

### *What You'll Need:*

- Protective Gloves
- Plier
- Wire Cutter
- Glue Gun
- Chicken Wire
- Wreath Frame
- Artificial Flowers
- Artificial Leaves

### 1 Measure the chicken wire



Firstly, roll out your chicken wire and place your wreath frame on top of it, to determine how much you will need.

### 2 Cut the chicken wire

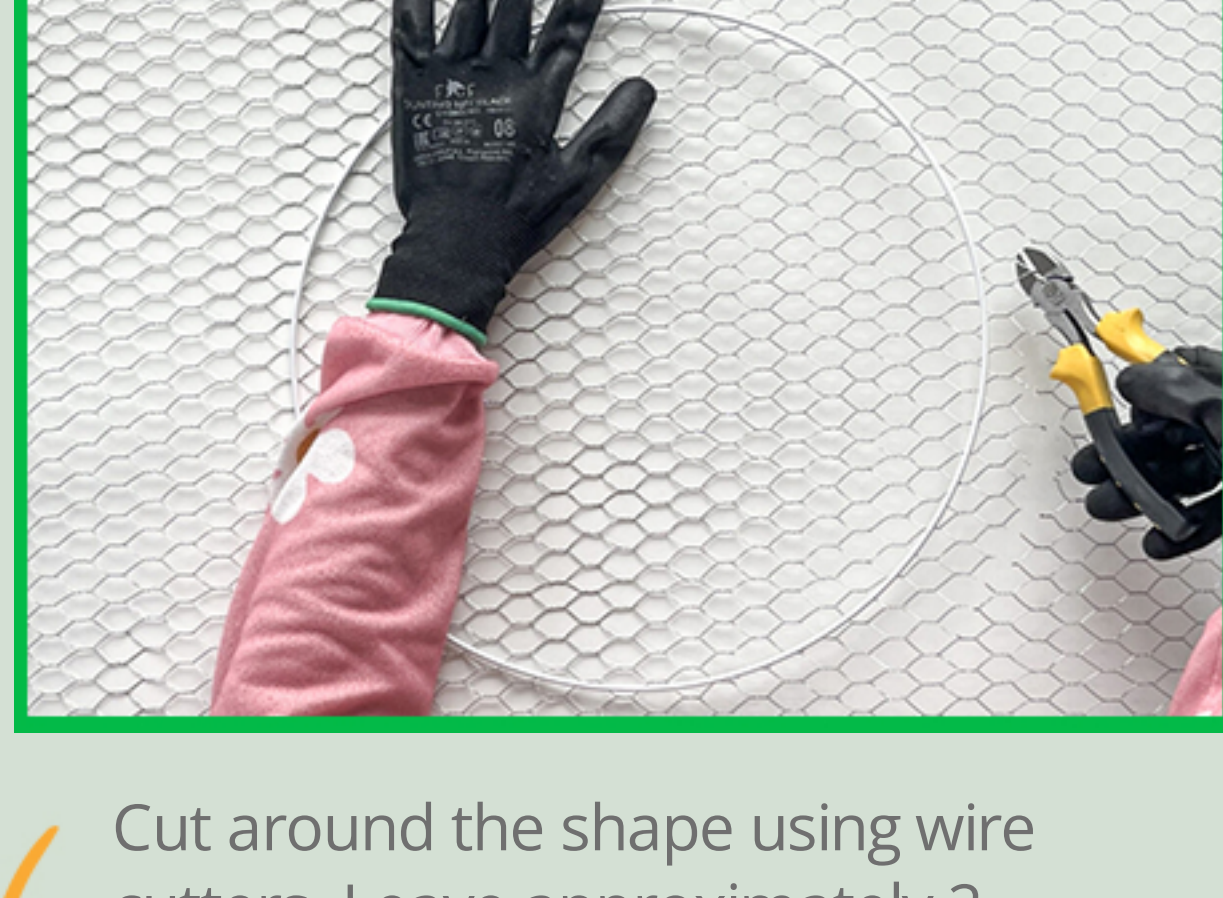

Cut around the shape using wire cutters. Leave approximately 2 centimetres extra on the sides.

### 3 Prepare the shape



Once you cut out your shape, discard the excess chicken wire. Then, place your cut-out chicken wire under the shape.

### 4 Wrap the edges

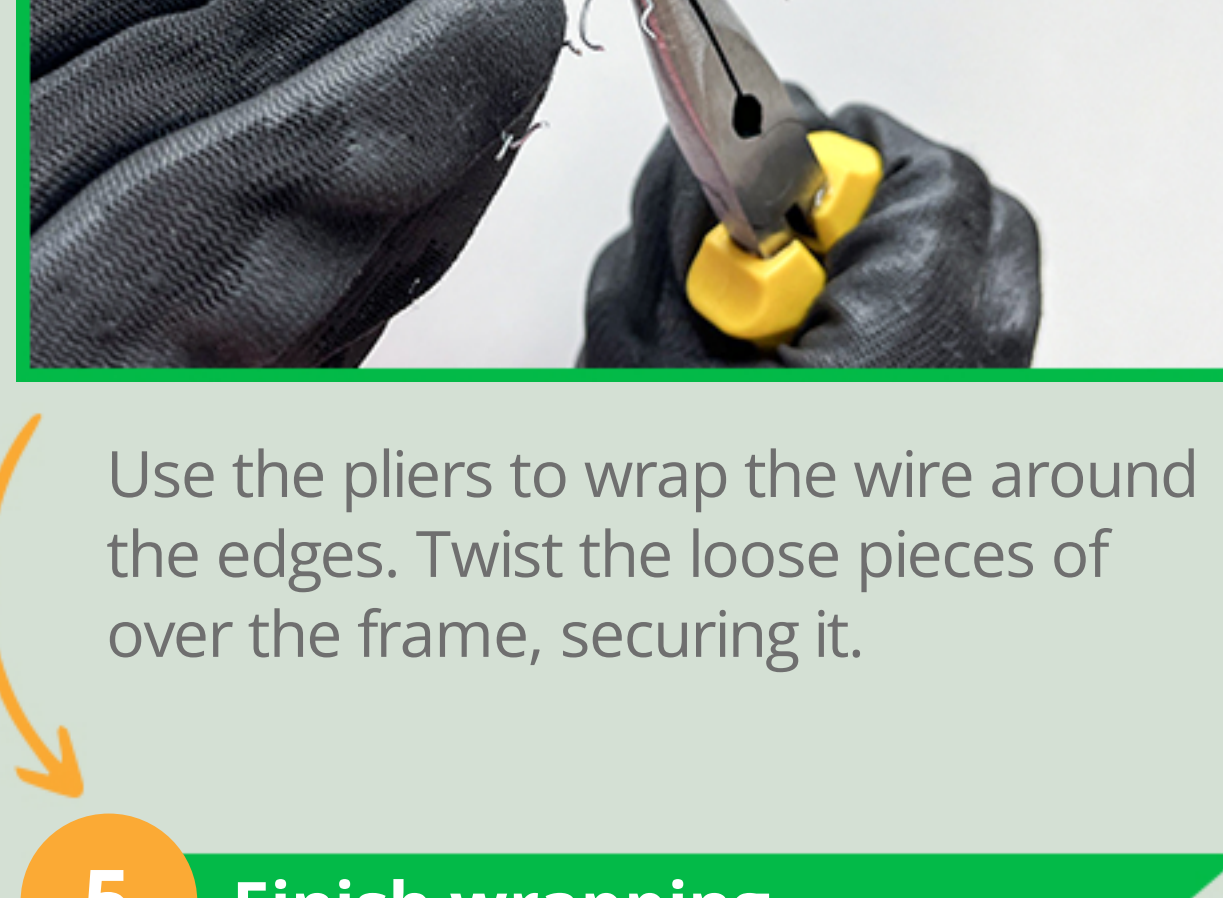

Use the pliers to wrap the wire around the edges. Twist the loose pieces of over the frame, securing it.

### 5 Finish wrapping



Once you finish with the wrapping, your shapes should look like this.

### 6 Paint the wreath



Paint the wreath white, using spray paint. Then, put it aside, allowing it to dry.

### 7 Finish wrapping

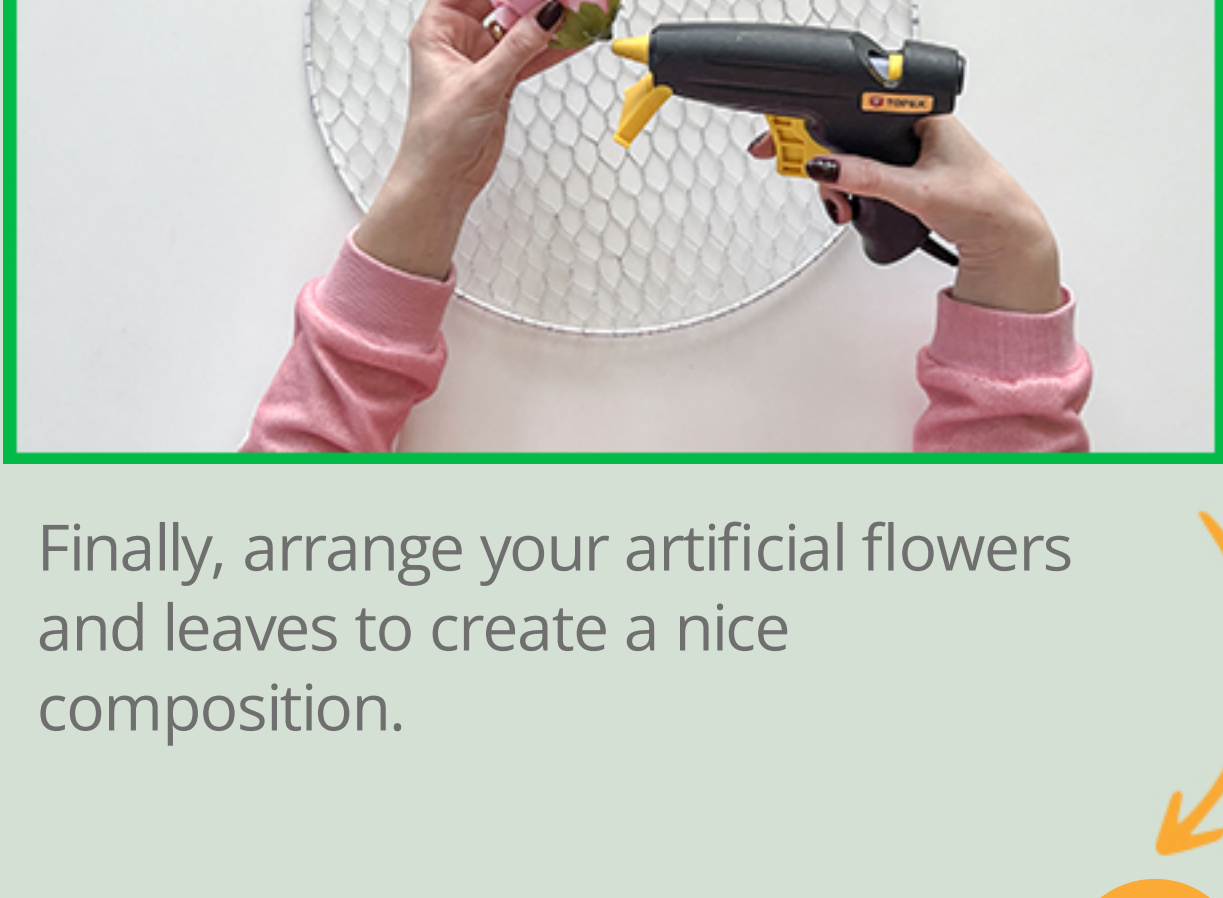

Finally, arrange your artificial flowers and leaves to create a nice composition.

### 8 Enjoy your spring wreath

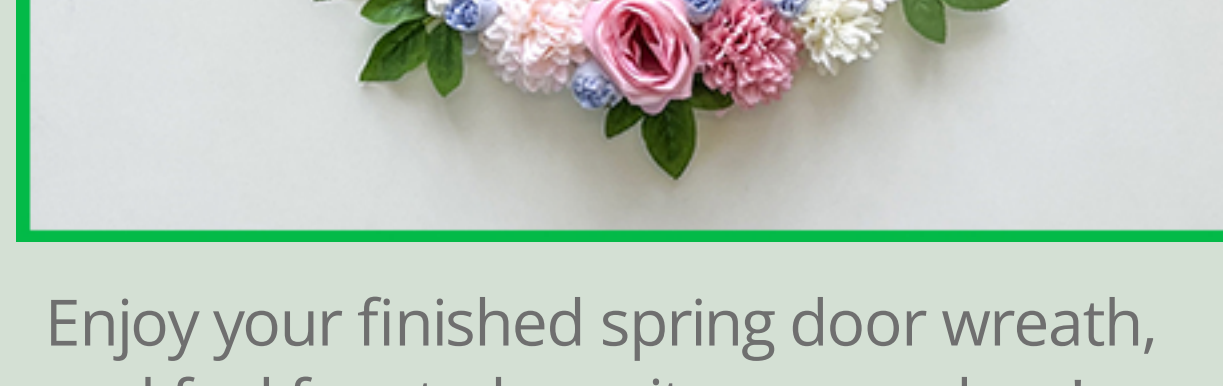

Enjoy your finished spring door wreath, and feel free to hang it on your door!